

REMOVAL

1. REMOVE TIMING BELT (See page [EM-15](#))
2. REMOVE NO.2 IDLER PULLEY (See page [EM-15](#))
3. REMOVE THROTTLE BODY (See page [SF-37](#))

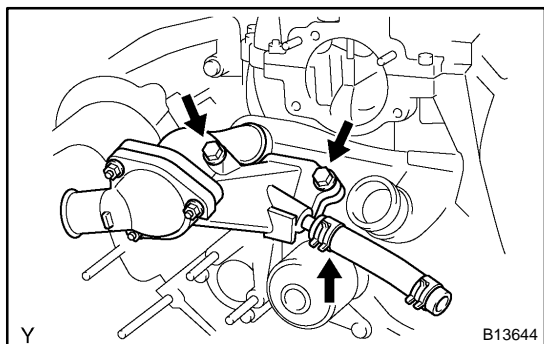

4. REMOVE WATER INLET AND INLET HOUSING ASSEMBLY

- (a) Remove the 2 bolts and water inlet and inlet housing assembly.
- (b) Remove the water bypass hose (from the throttle body) from the water inlet housing.
- (c) Remove the O-ring from the water inlet housing.

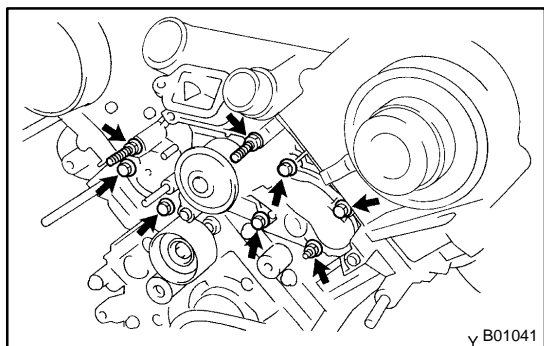

5. REMOVE WATER PUMP

- (a) Remove the 5 bolts, 2 stud bolts and nut.
- (b) Remove the water pump and gasket.
- (c) Remove the O-ring from the water bypass pipe.